

Department of Engineering
Dan Gaillet, P.E., County Engineer

3137 South Liberty Street, Canton, MS 39046
Office (601) 855-5670 FAX (601) 859-5857

MEMORANDUM

September 12, 2018

To: Sheila Jones, Supervisor, District I
Trey Baxter, Supervisor, District II
Gerald Steen, Supervisor, District III
David Bishop, Supervisor, District IV
Paul Griffin, Supervisor, District V

From: Dan Gaillet, P.E.
County Engineer



Re: CSpire
Calhoun Station Parkway

The Engineering Department recommends approval of the permit application for Cspire to bore 1,726 feet of fiber along Calhoun Station Parkway between Autobahn Loop (north & south).

MADISON COUNTY, MISSISSIPPI
PERMIT APPLICATION FOR USE AND OCCUPANCY
FOR THE CONSTRUCTION OR ADJUSTMENT OF A UTILITY
WITHIN COUNTY ROAD RIGHT-OF-WAY



UTILITY NAME C SPIRE

BY STEVE CASE

PHONE 662-590-3120 ADDRESS 1018 HIGHLAND COLONY PKWY, RIDGELAND

herein called APPLICANT, proposes to construct on CALHOUN PKWY & AUTOBANN LOOP

said facility to be installed between roads CHURCH RD and GLUCKSTADT RD
and within the road right-of-way, and hereby makes application to the County for construction permit. Attached
hereto are drawings or plans for the construction, which will not be changed or altered without approval of the
County Engineer, or his representative. Beginning in Section 21, Township B, Range
2, and ending in Section 21, Township B, Range 2.

Whereas, the Legislature of Mississippi has heretofore granted to the applicant the right to locate its facilities upon, across, under, over and along public highways and streets within the State of Mississippi; Applicant agrees to comply with applicable provisions of S.O.P. No. SAD II-2-8, Policy for the Accommodation of Utility Facilities within the Rights-of-Way of County Federal Aid and State Aid Highways (hereinafter referred to as the "Policy"), promulgated by the State Aid Engineer and dated January 1, 1983, and which is hereby made a part of this application Agreement, and agrees to perform the construction according to the applicable industry code and according to the plans and specifications for the Project.

The Applicant shall comply with all policies, procedures and construction practices as outlined in "A Policy for The Accommodation of Utility Facilities within the Right-of-Way of all Public County Roads", as adopted on May 1, 1992, by the Madison County Board of Supervisors.

The Applicant is 100% liable for verifying the location of County right-of-way and for locating permitted utilities within its limits. The Applicant is responsible for verifying the location of all storm drainage structures before boring.

The Applicant shall be responsible for the future maintenance and repair of the facilities. The Applicant shall make future adjustments in, or relocate, the facilities located within road or highway right-of-way when required for road or highway widening or other road or highway construction at no cost to the county. The Applicant Utility shall relocate said utilities within sixty (60) days of notification by County by registered mail, return receipt requested, unless otherwise designated by the County Engineer. Further, any maintenance, repair, or construction shall be done in such a manner as to occasion no unreasonable interference with the normal flow and safety to traffic and at the expense of the utility company. When reasonable care has been taken to locate said utility facilities within the right-of-way, the applicant understands that any damages caused by routine maintenance and construction by county forces shall be borne by the applicant Utility.

A general description of the size, type, nature, and extent of the Utility work to be done is as follows:

*BORE FIBEROPTIC CABLE ALONG THE EAST SIDE OF CALHOUN ROAD
LOCATED IN BACK 5 FT OF COUNTY ROW. MIN DEPTH 48"*

The Applicant is responsible for insuring that all utilities in the aforementioned description of work be laid at a minimum depth of 48".

The applicant understands and agrees that, except as herein granted, no right, title, claim, or easement to said road right-of-way is granted by the issuance of this permit and if this Utility Facility as listed in the general provisions of the Policy, it will be adjusted to comply with same without cost to the County, unless the variance from the Policy has been approved by the granting of the Permit pursuant to this Application.

The Applicant further understands that the Utility's engineering, plant, or other personnel will be responsible for the staking and construction supervision of the work set out above and as shown on the attached plans.

The applicant further agrees to indemnify and hold county harmless for any and all claims, accidents, damages, liabilities and expenses occasioned wholly, or in part, by any act or omission of applicant, its agents or employees. In case County shall, without fault on its own part, be made a party to any litigation commenced by or against applicant, then applicant shall protect and hold County harmless, and shall pay all costs, expenses and reasonable attorney's fees incurred or paid by County in connection with said litigation.

Madison County agrees to the following stipulations:

- (1) To cooperate with the Utility Company in every way to avoid conflicts in the location, construction, and maintenance of the County Highway and Utility Facility.
- (2) To pursue any and all legal means to see the Policy Standards, except to the extent of any variance shown on the plans filed herewith and approved, are complied with in the facility installation.
- (3) If the County Engineer or his authorized representative approved the drawing, sketches, and plans submitted by the Applicant, he shall so indicate by signing and dating the Permit Approval at the end of this application; and the Applicant may proceed with the installation; if the drawings, sketches, and plans are not approved, he shall promptly notify the Applicant, and advise it of the reason or reasons. He will also act as the duly appointed representative of the Board of Supervisors and will give his approval to the completed work as being in compliance with the location and standards shown in the Policy and in the Agreement for the installations.
- (4) That all joint highway construction and utility adjustment or relocation operations will comply with the requirements of Section S-105.06 and Section S-107-18, Mississippi Standard Specifications for State Aid Road and Bridge Construction, 1989 edition (or current edition).
- (5) Should any term of provision of this Applicant Agreement conflict with the law of the State of Mississippi, the Mississippi Constitution, or the United States Constitution, or impair or deny to the Applicant or the County any right protected thereby, it shall be deemed amended to conform to said law or Constitution.

WITNESS the signature of the Applicant this the 28 day of August, 2018

By: Steve Cox
(Applicant Signature)

Title: CONTRACTS & PERMITS



Dan Gaillet, P.E.
Madison County Engineer TGS

AGREED TO AND APPROVED BY:

Madison County Board President

Date: _____

ENTERED INTO THE MINUTES OF THE BOARD OF SUPERVISORS OF MADISON COUNTY,
MISSISSIPPI ON THIS _____ DAY OF _____, _____.



ASBUILT INFORMATION

FIELD ENGINEER: NAME: CHRIS DONALD
PROJECT MANAGER: NAME:
CONSTRUCTION: NAME:
SUB CONTRACTOR: NAME:
INSPECTOR: NAME:
PHONE#:
CONSTRUCTION COMMENCED: DATE:
CONSTRUCTION COMPLETED: DATE:
FIBER INSTALLED: DATE:
FINAL CLEANUP: DATE:



<<	PERMITS	>>
CITY:	GLUCKSTADT	

NVSWO.OSP.27116
CSF.OSFPMS-MADCTY.MS

PROPOSED FIBER BUILD
Barnetts Body Shop
8-27-18



1018 HIGHLAND COLONY PARKWAY
SUITE 340
RIDGELAND, MISSISSIPPI 39157
1-800-342-3716

ROUTE MAP

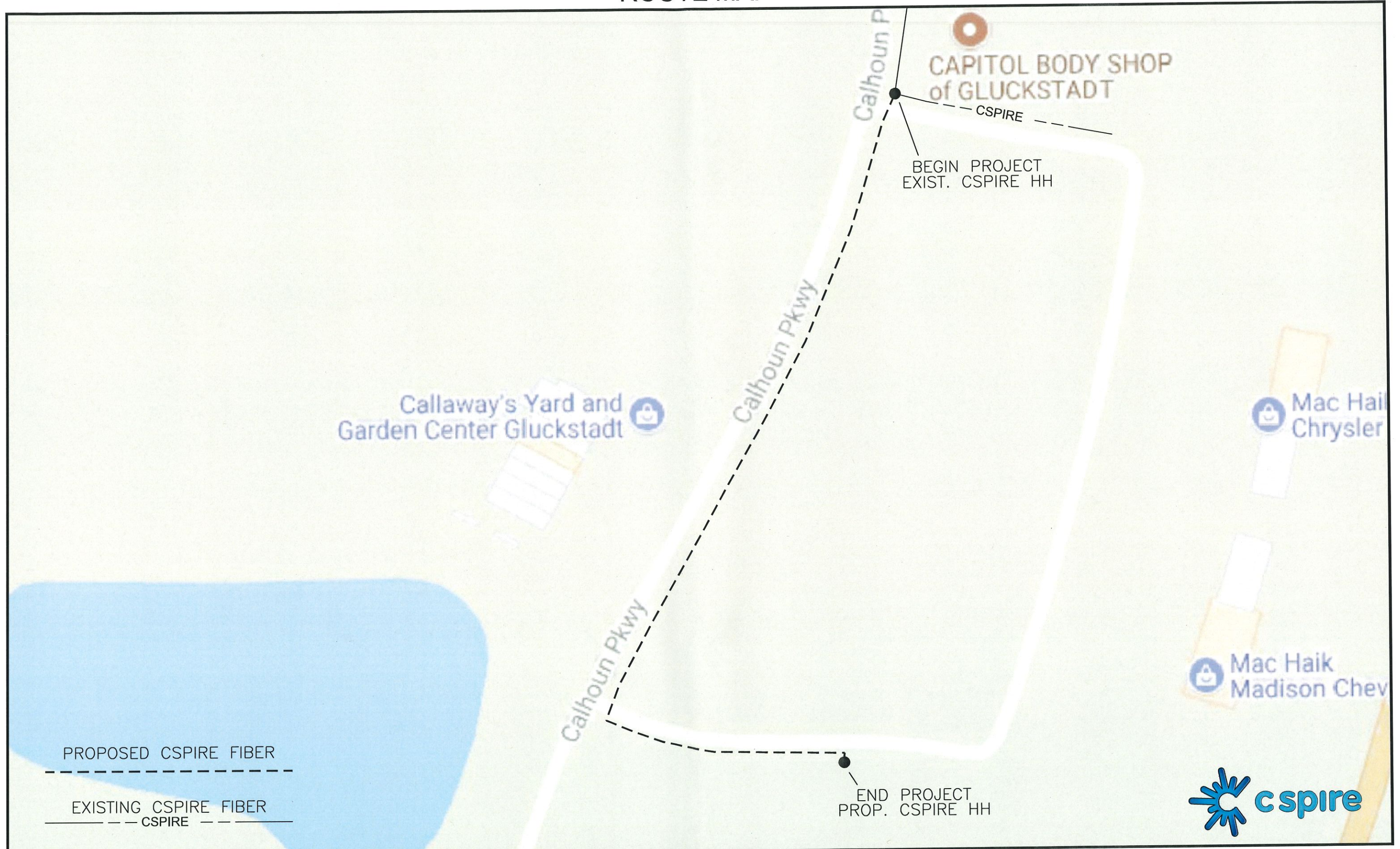

CAPITOL BODY SHOP
of GLUCKSTADT

BEGIN PROJECT
EXIST. CSPIRE HH

Callaway's Yard and
Garden Center Gluckstadt

Mac Haik
Chrysler

Mac Haik
Madison Chev

PROPOSED CSPIRE FIBER

EXISTING CSPIRE FIBER
CSPIRE

END PROJECT
PROP. CSPIRE HH



Barnett's Body Shop



CONSTRUCTION NOTES:

- ALL CONDUIT WILL BE 4" ID SCHEDULE 40 (ie. PVC OR BSP/GSP, MANUFACTURED SPLIT PVC OR SPLIT BSP/GSP), UNLESS SPECIFIED OTHERWISE.
- CONTRACTOR IS RESPONSIBLE FOR LOCATING ALL UTILITIES 48 HOURS PRIOR TO CONSTRUCTION ACTIVITY. CALL ONE CALL SYSTEM @ 1-800-227-6477.
- ALL UNDERGROUND OBSTRUCTIONS, WHEN LOCATED, WILL REQUIRE THE PLACEMENT OF A BURIED CABLE MARKER AND THE PLACEMENT OF 4" MANUFACTURED SPLIT PVC, BSP/GSP OVER OR UNDER EACH OBSTRUCTION.
- SHORING MAY BE REQUIRED AND SHALL COMPLY TO O.S.H.A. STANDARDS.
- ALL BURIED CONDUIT/CABLE WILL BE PLACED AT 60" MINIMUM COVER CROSSING ALL STATE AND OR COUNTY ROADS AND ALL CREEK BEDS UNLESS SPECIFIED OTHERWISE ON THE CONSTRUCTION DRAWINGS.
- MECHANICAL PROTECTION SHALL BE REQUIRED ANYTIME A 36" MINIMUM COVER IS UNOBTAINABLE UNLESS SPECIFIED OTHERWISE ON THE CONSTRUCTION DRAWINGS.
- ALL 90 DEGREE BENDS IN CONDUIT CONSTRUCTION WILL BE A MINIMUM 38.2" RADIUS UNLESS SPECIFIED OTHERWISE. ALL SPLIT CONDUIT BENDS AND SOLID PVC BENDS SHALL REQUIRE CONCRETE ENCASEMENT, UNLESS SPECIFIED OTHERWISE.
- OPERATIONS PERSONNEL TO BE CONTACTED BY THE CONTRACTOR 48 HOURS PRIOR TO CONSTRUCTION.
- ALL STATIONING IS BASED ON AS-BUILT INFORMATION, THEREFORE SOME VARIANCE SHOULD BE ANTICIPATED. ADJUST AS NEEDED.
- RAILROAD COMMUNICATION AND SIGNAL CABLES TO BE LOCATED PRIOR TO CONSTRUCTION ACTIVITY. RAILROAD TO BE GIVEN 48 HOURS NOTICE PRIOR TO CONSTRUCTION
- ALL BURIED CONDUIT/CABLE WILL BE PLACED AT 24" MINIMUM BELOW THE LOWEST POINT OF EXISTING CITY UTILITY BEING CROSSED.
- ALL BURIED CONDUIT/CABLE WILL BE PLACED AT 48" MINIMUM BELOW ALL CITY & OR SURFACE STREET(S) WHERE NO UTILITY IS CROSSED.
- CONSTRUCTION CONTRACTOR SHALL PLACE MARKER POLES AT ALL H.H. LOCATIONS & AT EVERY MAJOR P.I. CONTRACTOR WILL PLACE MARKER POLES DURING THE CONSTRUCTION PHASE.

GENERAL NOTES:

- ALL WORK TO BE DONE WITH EXTREME CAUTION, FIBER OPTIC CABLE CARRYING TRAFFIC AND LOSS OF SERVICE WILL RESULT IN LOSS OF REVENUE.
- ALL WORK TO BE PERFORMED IN STRICT ACCORDANCE WITH THE APPLICABLE CODES OR REQUIREMENTS OF ANY REGULATING GOVERNMENTAL AGENCY, TELEPAK, OR THE RIGHT-OF-WAY GRANTOR.
- LOCATIONS OF SOME OF THE PHYSICAL FEATURES WERE OBTAINED FROM DATED RAILROAD EVALUATION MAPS OR OTHER DRAWINGS, AND MAY BE AS SHOWN OR DEPICTED ON THESE DRAWINGS.
- UNDERGROUND UTILITIES HAVE BEEN PLOTTED FROM AVAILABLE RECORDS AND FIELD OBSERVATIONS, BUT ARE NOT NECESSARILY EXACT. THEREFORE, UTILITY LOCATIONS WILL BE VERIFIED AT LEAST 100 FEET IN ADVANCE OF TRENCHING OR PLOWING, SO THAT CHANGES IN CABLE PLACEMENT CAN BE MADE IN EVENT OF CONFLICTS.
- ALL KNOWN BURIED OBSTRUCTIONS ARE SHOWN ON THE CONSTRUCTION DRAWINGS. ANY AND ALL OTHERS ENCOUNTERED ARE ALSO THE RESPONSIBILITY OF THE CONTRACTOR TO LOCATE, PROTECT, AND REPAIR, IF DAMAGED.
- ANY AND ALL IMPROVEMENTS, SUCH AS, ASPHALT OR CONCRETE PAVEMENT, CURBS, GUTTERS, WALKS, DRAINAGE DITCHES, EMBANKMENTS, SHRUBS, TREES, GRASS SOD, ETC., IF DAMAGED, SHALL BE RESTORED TO ORIGINAL OR BETTER CONDITION.
- EQUIPMENT TYPES SPECIFIED HEREIN (ie: "BACKHOE, "SWAMP PLOW", ETC.) ARE SUGGESTIONS ONLY AND ARE NOT INTENDED AS REQUIREMENTS. CONTRACTOR WILL BE NOTIFIED AS TO EXCEPTIONS.

TRAFFIC CONTROL NOTES:

ALL WORK SHALL COMPLY WITH THE UNIFORM TRAFFIC CONTROL MANUAL. (1998 EDITION OF MUTCD, REVISION 3) OR NEWER VERSIONS OF THIS MANUAL.

NOMENCLATURE

DEFINITION

- | | |
|---------------|---|
| 1. BM2-8 : | PLACEMENT OF EIGHT FOOT GROUND ROD OUTSIDE OF HAND HOLE SIX INCHES BELOW GROUND LEVEL WITH PLACEMENT OF GROUND WIRE WITH THE CONNECTOR. |
| 2. BM53F : | PLACEMENT OF PLASTIC MARKER POLE, MINIMUM OF 30" IN GROUND AS INDICATED BY DRAWINGS. |
| 3. BM53F(A) : | PLACEMENT OF LOCATE MARKER POST AND PLACEMENT OF WIRE INSIDE OF POST FROM GROUND ROD AND SPLICE CLOSURE TO BE TERMINATED IN POST FOR LOCATION OF FACILITIES AS INDICATED ON DRAWINGS. |
| 4. BM72 : | RESTORATION OF ASPHALT PER SQ. FT. AS REQUIRED BY COMPANY REP. |
| 5. BM73 : | RESTORATION OF CONCRETE PER SQ. FT. AS REQUIRED BY COMPANY REP. |
| 6. UO-144 : | PLACEMENT OF 144 COUNT FIBER INTO INNER-DUCT, LEAVING SLACK IN HAND HOLES AS INDICATED ON DRAWINGS. PRICE PER PLACEMENT IS ON 'PER FOOT' BASIS. |
| 7. UO-24 : | PLACEMENT OF 24 COUNT FIBER INTO INNER-DUCT, LEAVING SLACK IN HAND HOLES AS INDICATED ON DRAWINGS. PRICE FOR PLACEMENT IS ON A 'PER FOOT' BASIS. |

CLARIFICATION NOTES:

NOTE: CALLOUTS WILL BE PLACED ON EACH DRAWING INDICATING FOLLOWING:

- MATERIAL AMOUNT
- DEPTH IF BURIED
- SIZE OF FIBER
- SIZE OF HDPE
- SIZE OF STRAND
- CABLE ID

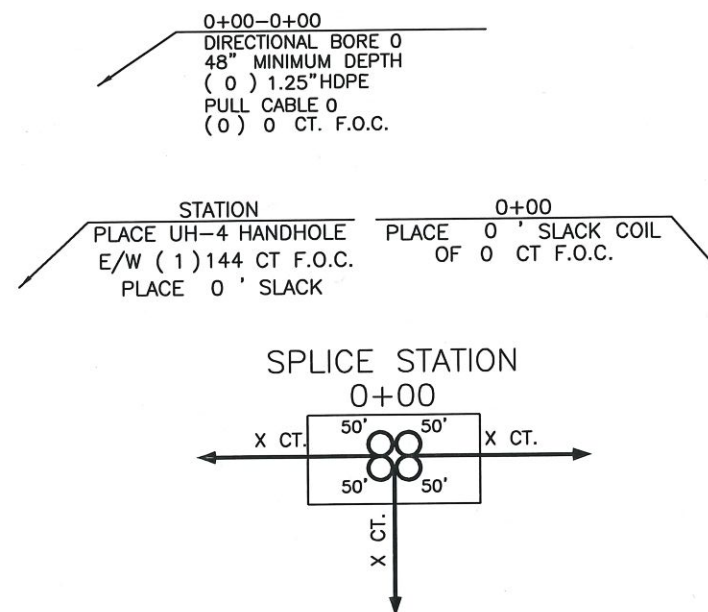

SYMBOL

- | | |
|--|------|
| | NONE |
| | NONE |
| | NONE |
| | NONE |
| | NONE |

FILE NAME T-01	
PROJECT CITY -	
FULL FILENAME T-01.dwg	
DATE	DESCRIPTION CONSTRUCTION
SHEET 1	DRAWN BY
SCALE 1"=50'	PAGE 1

REVISIONS

REV.	DESCRIPTION	INITIALS	DATE

MATERIAL LIST

ITEM	DESCRIPTION	QUANTITY
1	TOTAL CABLE FT.	0'
2	DIR-BORE CABLE	0'
3	PULL CABLE	0'
4	BURIED SLACK	0'
5	1.25" HDPE	0'
6	5" HDPE CASING	0'
7	HANDHOLES	0
8	MANHOLES	0
9	SPLICE CLOSURE	0
10	H-POSTS	0
11	GROUND RODS	0
12	AERIAL CABLE	0'
13	RISERS	0
14		

PREPARED BY



PREPARED FOR



MAP NUMBER

DISCLAIMER

EXCEPT AS MAY BE OTHERWISE PROVIDED BY CONTRACT, THESE DRAWINGS AND SPECIFICATIONS SHALL REMAIN THE PROPERTY OF CSPIRE FIBER. BEING ISSUED IN STRICT CONFIDENCE AND SHALL NOT BE REPRODUCED, COPIED, OR USED FOR ANY PURPOSE WITHOUT SPECIFIC WRITTEN PERMISSION.

NOTIFY ALL UTILITIES 72 HOURS PRIOR TO CONSTRUCTION ACTIVITY. ONE CALL SYSTEM @ 1-800-227-6477

SYMBOLS KEY

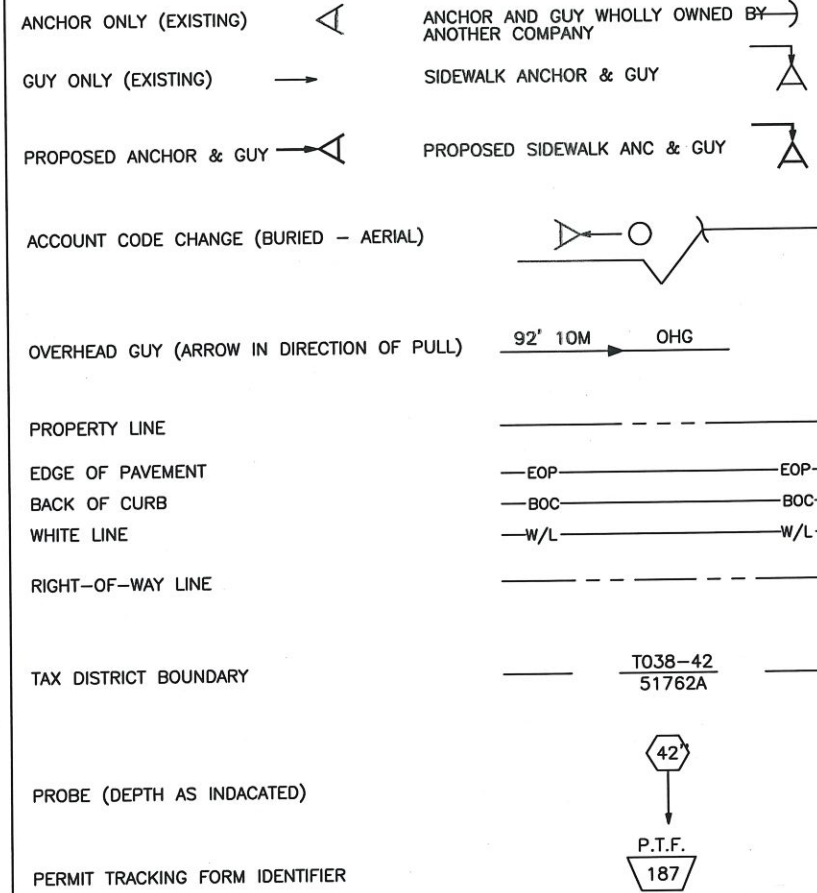
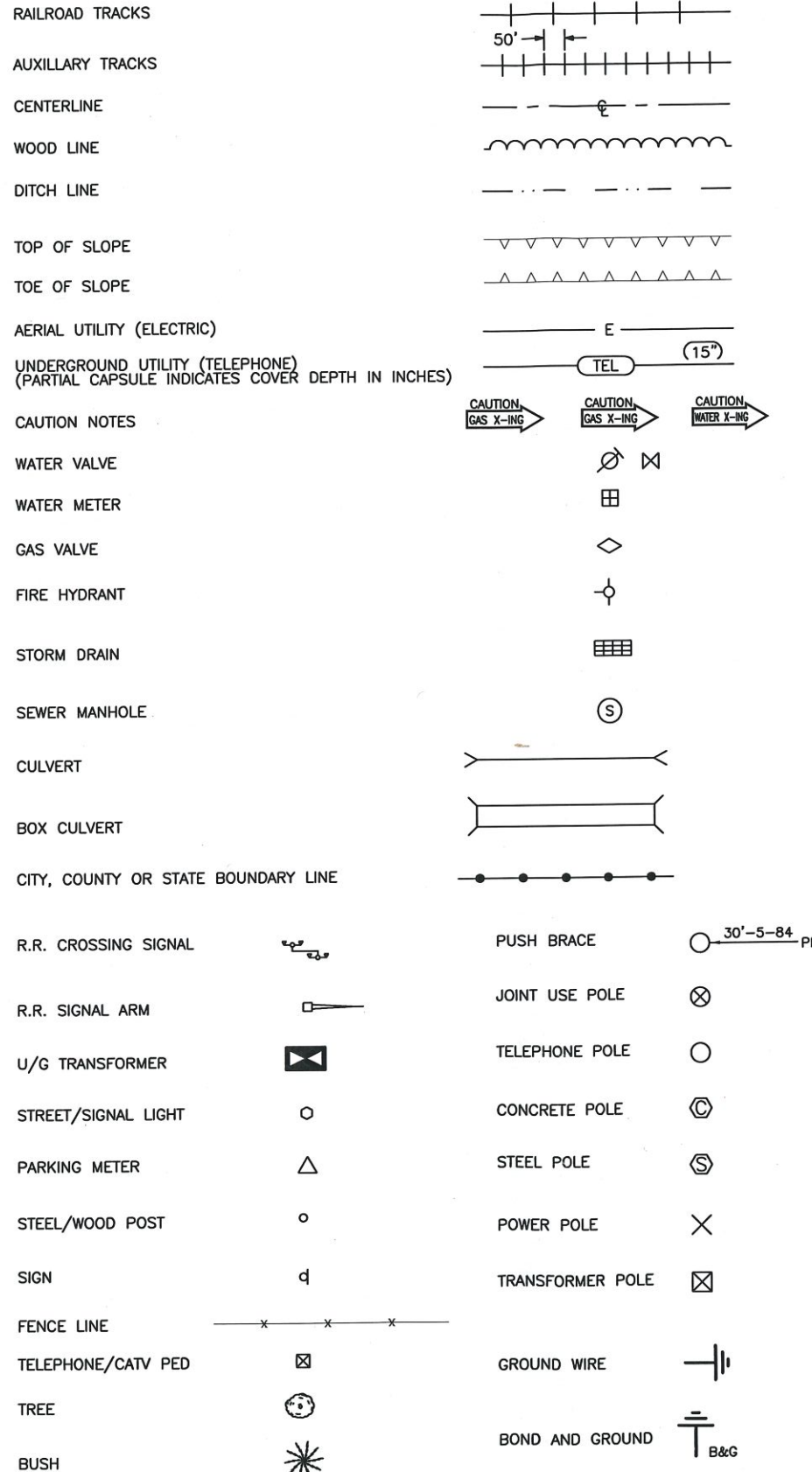
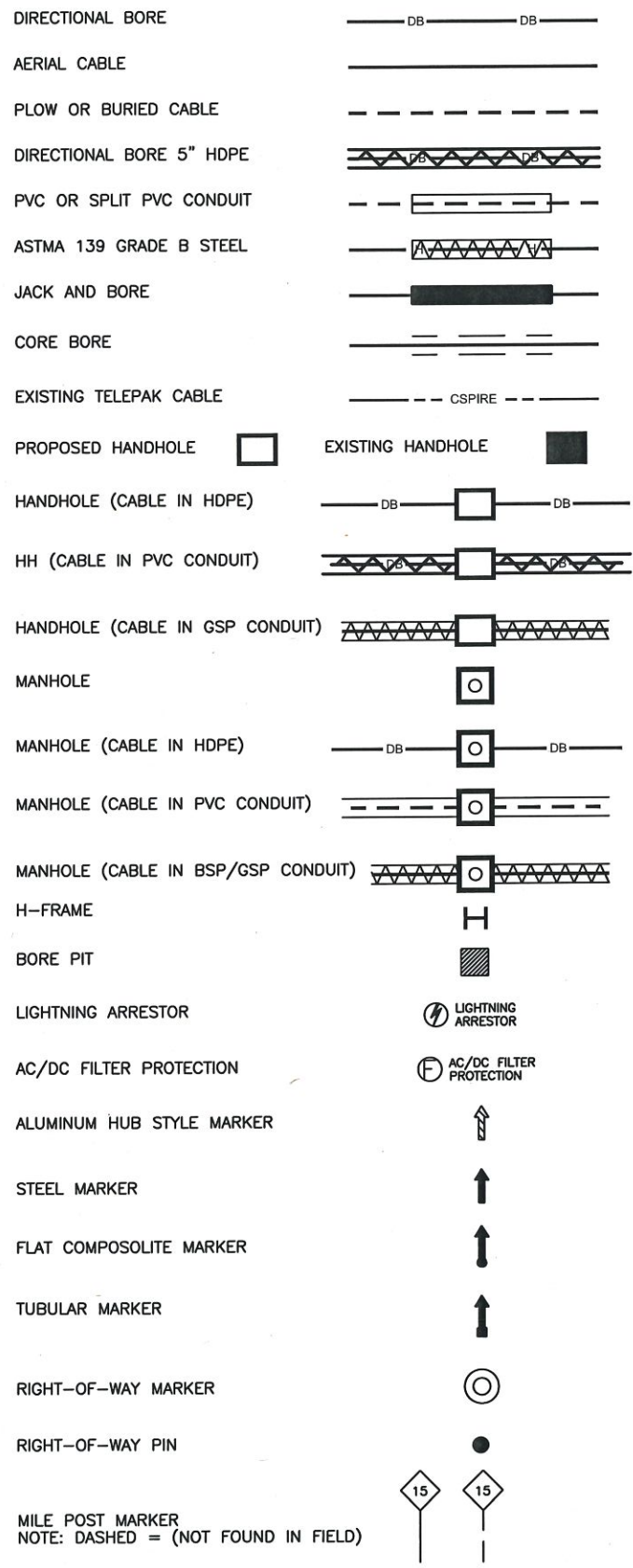

POLE ATTACHMENT ABBREVIATIONS

PWR	POWER ATTACHMENT	PWR OHG	POWER OVERHEAD GUY
TRI	TRIPLEX	CATV OHG	CATV OVERHEAD GUY
COMM	COMMUNICATIONS ATTACHMENT	CAP BANK	CAPACITOR BANK
CATV	CATV ATTACHMENT	CLTCKT	FIRE ALARM CIRCUIT
SL	STREET LIGHT	PWR DIP	POWER DIP
TSIG	TRAFFIC SIGNAL	COMM DIP	COMMUNICATIONS DIP
MDW	MULTI DROP WIRE	CATV DIP	CATV DIP
COMM OHG	COMMUNICATIONS OVERHEAD GUY	TEOP	TRAFFIC LIGHT
FL	FLOOD LIGHT	TGUY	TRAFFIC GUY
WH	WEATHER HEAD	MS	MIDSPAN
TRAN	TRANSFORMER	OHG	OVERHEAD GUY
TELEPAK	TELEPAK ATTACHMENT	TOP	TOP OF POLE
SEC	SECONDARY POWER	NEU	NEUTRAL



FILE NAME T-02	
PROJECT CITY -	
FULL FILENAME T-02.dwg	
DATE	DESCRIPTION
CONSTRUCTION	
SHEET 2	DRAWN BY
SCALE 1"=50'	PAGE 2

REVISIONS			
REV.	DESCRIPTION	INITIALS	DATE

MATERIAL LIST		
ITEM	DESCRIPTION	QUANTITY
1	TOTAL CABLE FT.	0'
2	DIR-BORE CABLE	0'
3	PULL CABLE	0'
4	BURIED SLACK	0'
5	1.25" HDPE	0'
6	5" HDPE CASING	0'
7	HANDHOLES	0
8	MANHOLES	0
9	SPLICE CLOSURE	0
10	H-POSTS	0
11	GROUND RODS	0
12	AERIAL CABLE	0'
13	RISERS	0
14		

PREPARED BY

PREPARED FOR

MAP NUMBER		
DISCLAIMER		
EXCEPT AS MAY BE OTHERWISE PROVIDED BY CONTRACT: THESE DRAWINGS AND SPECIFICATIONS SHALL REMAIN THE PROPERTY OF CSPIRE FIBER. BEING ISSUED IN STRICT CONFIDENCE AND SHALL NOT BE REPRODUCED, COPIED, OR USED FOR ANY PURPOSE WITHOUT SPECIFIC WRITTEN PERMISSION.		

NOTIFY ALL UTILITIES 72 HOURS PRIOR TO CONSTRUCTION ACTIVITY.
ONE CALL SYSTEM @ 1-800-227-6477

UH-5

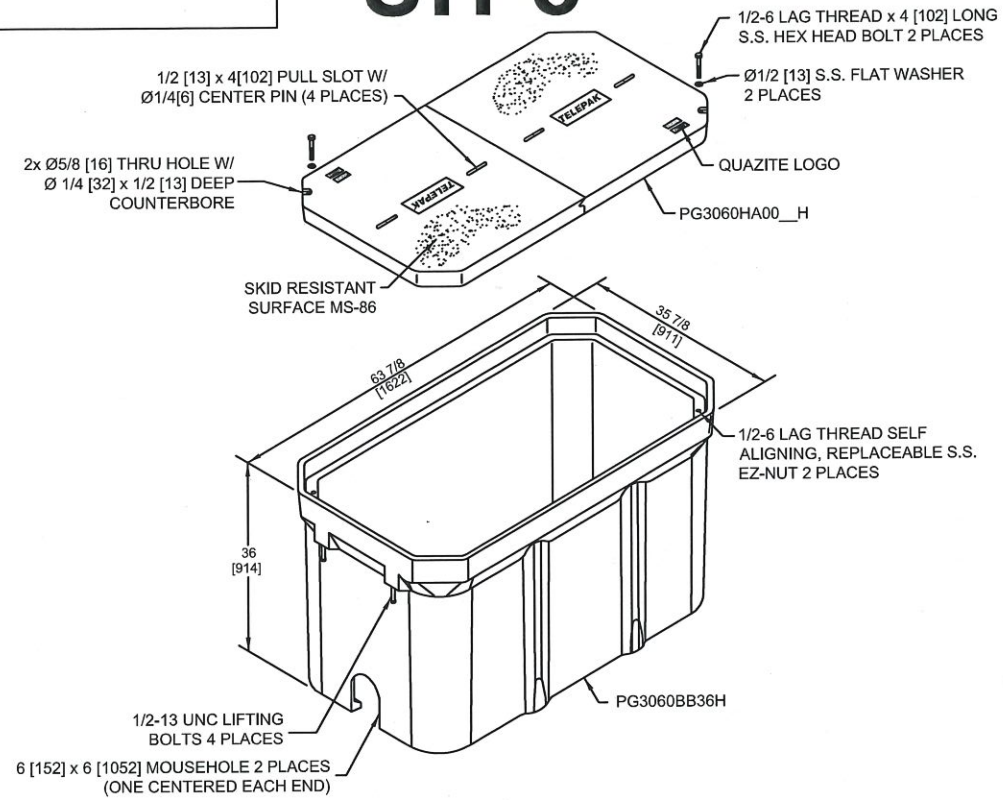

UH-4

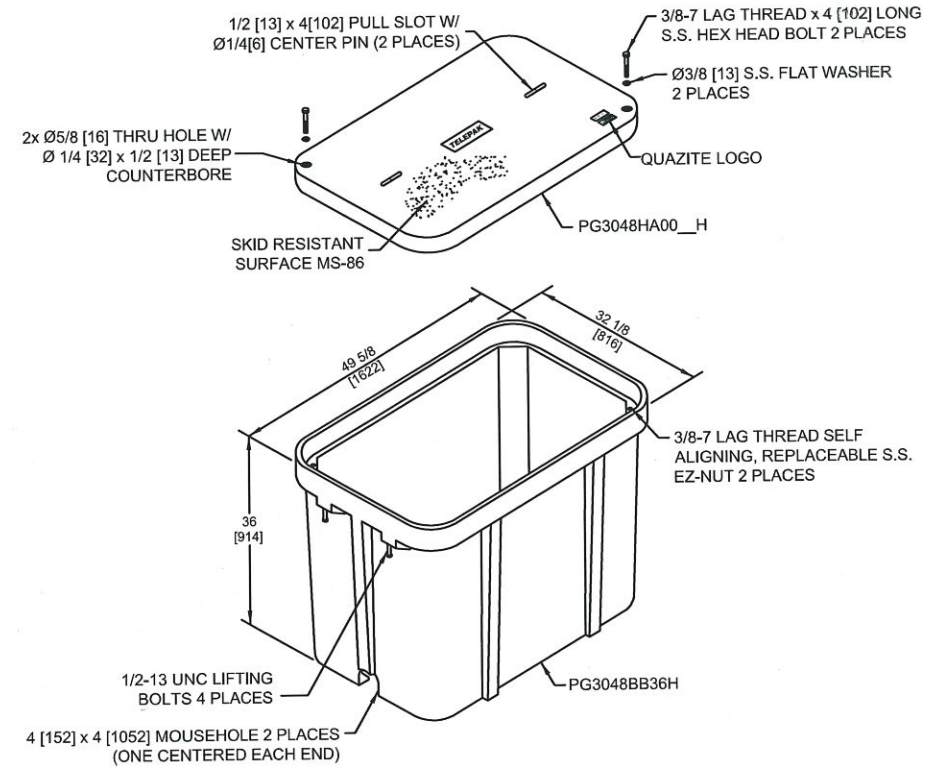

UH-3

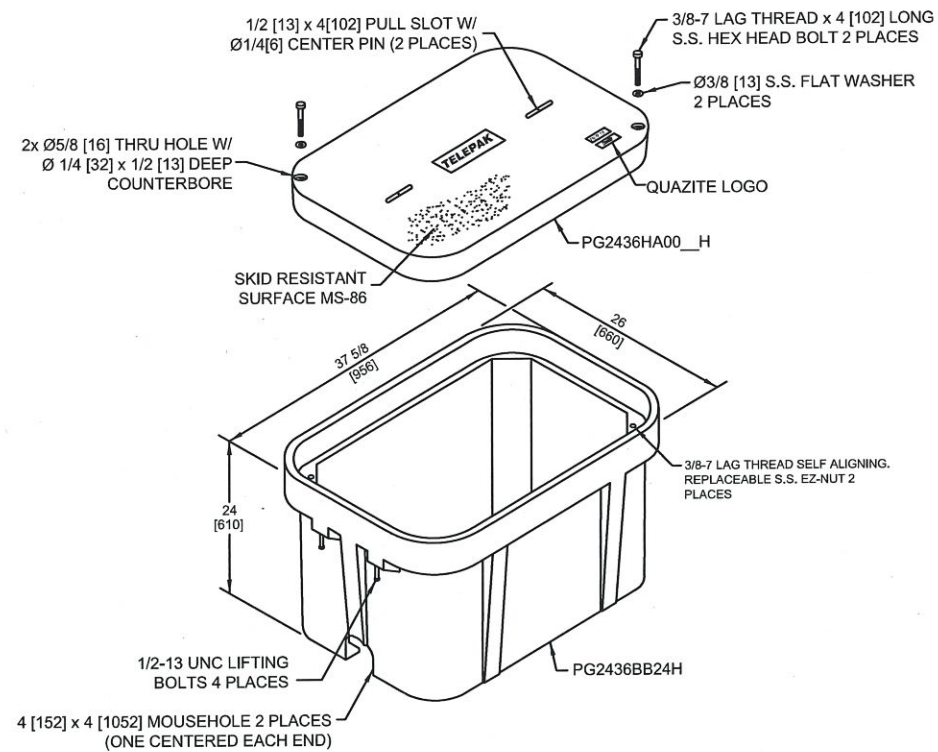

UH-2

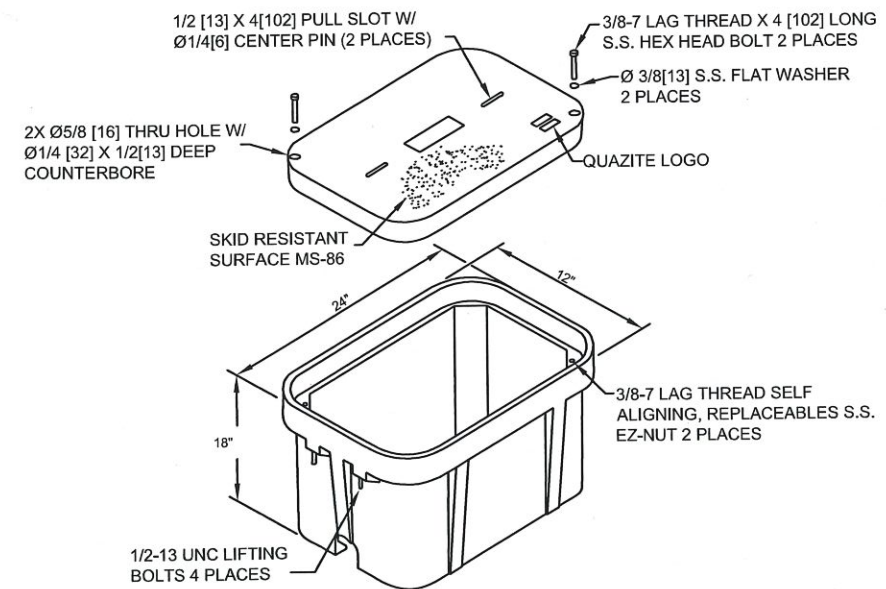

FILE NAME T-05

PROJECT CITY -

FULL FILENAME T-05.dwg

DATE	DESCRIPTION
SHEET	DRAWN BY
SCALE	PAGE
1"=50'	5

REVISIONS

REV.	DESCRIPTION	INITIALS	DATE

MATERIAL LIST

ITEM	DESCRIPTION	QUANTITY
1	TOTAL CABLE FT.	0'
2	DIR-BORE CABLE	0'
3	PULL CABLE	0'
4	BURIED SLACK	0'
5	1.25" HDPE	0'
6	5" HDPE CASING	0'
7	HANDHOLES	0
8	MANHOLES	0
9	SPLICE CLOSURE	0
10	H-POSTS	0
11	GROUND RODS	0
12	AERIAL CABLE	0'
13	RISERS	0
14		

PREPARED BY



PREPARED FOR



MAP NUMBER

DISCLAIMER

EXCEPT AS MAY BE OTHERWISE PROVIDED BY CONTRACT: THESE DRAWINGS AND SPECIFICATIONS SHALL REMAIN THE PROPERTY OF CSPIRE FIBER. BEING ISSUED IN STRICT CONFIDENCE AND SHALL NOT BE REPRODUCED, COPIED, OR USED FOR ANY PURPOSE WITHOUT SPECIFIC WRITTEN PERMISSION.

NOTIFY ALL UTILITIES 72 HOURS PRIOR TO CONSTRUCTION ACTIVITY.
ONE CALL SYSTEM © 1-800-227-6477

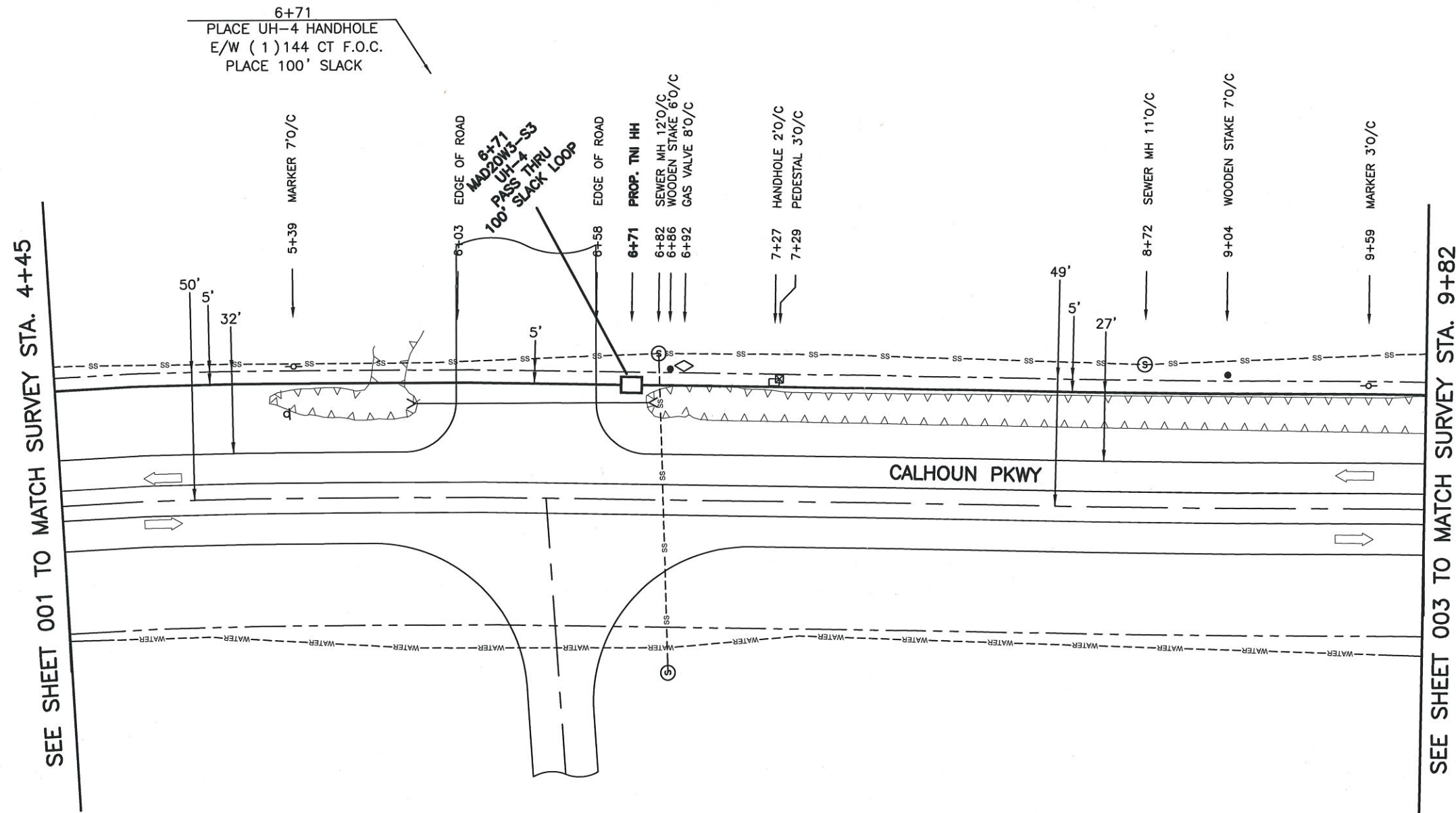

6+71
PLACE UH-4 HANDHOLE
E/W (1) 144 CT F.O.C.
PLACE 100' SLACK

6+71
MAD20W3-S3
UH-4
PASS THRU
100' SLACK LOOP

6+71 PROP. TMI HH
6+82 SEWER MH 12"O/C
6+86 WOODEN STAKE 6"O/C
6+92 GAS VALVE 8"O/C

7+27 HANDHOLE 2"O/C
7+29 PEDESTAL 3"O/C

8+72 SEWER MH 11"O/C

9+04 WOODEN STAKE 7"O/C

9+59 MARKER 3"O/C

SEE SHEET 001 TO MATCH SURVEY STA. 4+45

SEE SHEET 003 TO MATCH SURVEY STA. 9+82

4+45-9+82
DIRECTIONAL BORE 537'
48" MINIMUM DEPTH
(2) 1.25" HDPE
PULL CABLE 537'
(1) 144 CT. F.O.C.

FILE NAME BBS-002	
PROJECT CITY - GLUCKSTADT, MS	
FULL FILENAME BBS-002.dwg	
DATE 08-27-18	DESCRIPTION CONSTRUCTION
SHEET 002	DRAWN BY S.WALKER
SCALE 1"=50'	PAGE 002

REVISIONS			
REV.	DESCRIPTION	INITIALS	DATE

MATERIAL LIST		
ITEM	DESCRIPTION	QUANTITY
1	TOTAL CABLE FT.	637'
2	DIR-BORE CABLE	537'
3	PULL CABLE	0'
4	BURIED SLACK	100'
5	1.25" HDPE	1074'
6	5" HDPE CASING	0'
7	HANDHOLES	1
8	MANHOLES	0
9	SPLICE CLOSURE	0
10	H-POSTS	0
11	GROUND RODS	0
12	AERIAL CABLE	0'
13	RISERS	0
14		

PREPARED BY

PREPARED FOR

MAP NUMBER		
001	002	003

DISCLAIMER
EXCEPT AS MAY BE OTHERWISE PROVIDED BY CONTRACT: THESE DRAWINGS AND SPECIFICATIONS SHALL REMAIN THE PROPERTY OF CSPIRE FIBER. BEING ISSUED IN STRICT CONFIDENCE AND SHALL NOT BE REPRODUCED, COPIED, OR USED FOR ANY PURPOSE WITHOUT SPECIFIC WRITTEN PERMISSION.

NOTIFY ALL UTILITIES 72 HOURS PRIOR TO CONSTRUCTION ACTIVITY.
ONE CALL SYSTEM ☎ 1-800-227-6477

SEE SHEET 002 TO MATCH SURVEY STA. 9+82

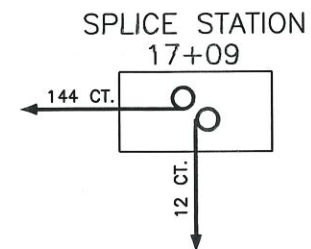
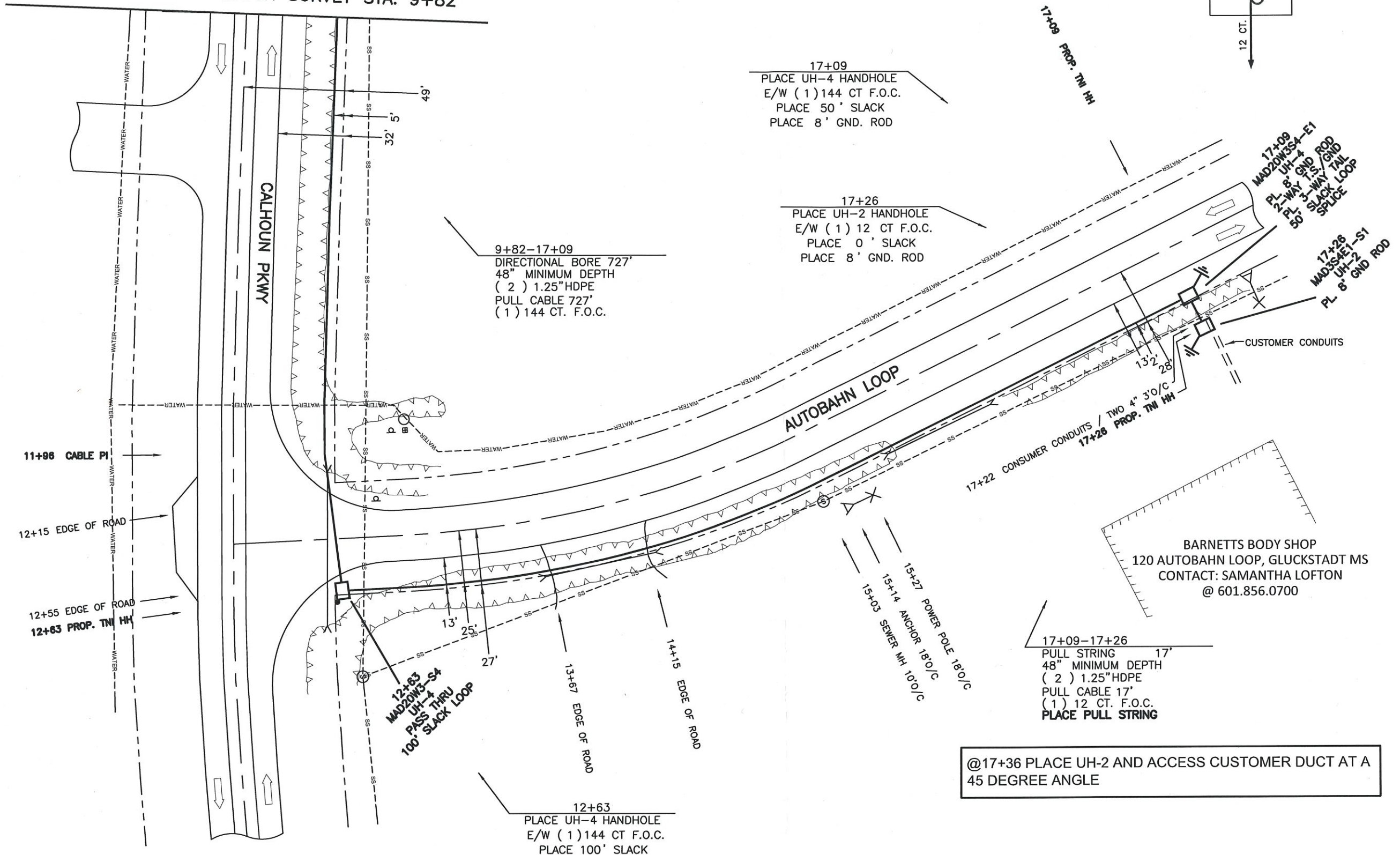

17+09
PLACE UH-4 HANDHOLE
E/W (1) 144 CT F.O.C.
PLACE 50' SLACK
PLACE 8' GND. ROD

17+26
PLACE UH-2 HANDHOLE
E/W (1) 12 CT F.O.C.
PLACE 0' SLACK
PLACE 8' GND. ROD

9+82-17+09
DIRECTIONAL BORE 727'
48" MINIMUM DEPTH
(2) 1.25" HDPE
PULL CABLE 727'
(1) 144 CT. F.O.C.

17+09
MAD20W3S4-E1
PL 8' GND ROD
PL 2-WAY T.S./GND
PL 3-WAY TAIL
50' SLACK LOOP
SPLICE

17+28
MAD3S4E1-S1
UH-2
PL 8' GND ROD

17+09-17+26
PULL STRING 17'
48" MINIMUM DEPTH
(2) 1.25" HDPE
PULL CABLE 17'
(1) 12 CT. F.O.C.
PLACE PULL STRING

@17+36 PLACE UH-2 AND ACCESS CUSTOMER DUCT AT A 45 DEGREE ANGLE

12+63
PLACE UH-4 HANDHOLE
E/W (1) 144 CT F.O.C.
PLACE 100' SLACK



FILE NAME BBS-003	
PROJECT CITY - GLUCKSTADT, MS	
FULL FILENAME BBS-003.dwg	
DATE 08-27-18	DESCRIPTION CONSTRUCTION
SHEET 003	DRAWN BY S.WALKER
SCALE 1"=50'	PAGE 003

REVISIONS

REV.	DESCRIPTION	INITIALS	DATE

MATERIAL LIST

ITEM	DESCRIPTION	QUANTITY
1	TOTAL CABLE FT.	894'
2	DIR-BORE CABLE	744'
3	PULL CABLE	0'
4	BURIED SLACK	150'
5	1.25" HDPE	1488'
6	5" HDPE CASING	17'
7	HANDHOLES	3
8	MANHOLES	0
9	SPLICE CLOSURE	1
10	H-POSTS	0
11	GROUND RODS	2
12	AERIAL CABLE	0'
13	RISERS	0
14		

PREPARED BY



PREPARED FOR



MAP NUMBER

003

DISCLAIMER

EXCEPT AS MAY BE OTHERWISE PROVIDED BY CONTRACT, THESE DRAWINGS AND SPECIFICATIONS SHALL REMAIN THE PROPERTY OF CSPIRE FIBER. BEING ISSUED IN STRICT CONFIDENCE AND SHALL NOT BE REPRODUCED, COPIED, OR USED FOR ANY PURPOSE WITHOUT SPECIFIC WRITTEN PERMISSION.

NOTIFY ALL UTILITIES 72 HOURS PRIOR TO CONSTRUCTION ACTIVITY.
ONE CALL SYSTEM © 1-800-227-6477